

CPE726

26 Litre SINGLE TANK ELECTRIC PASTA COOKER



- Steel unit with moulded top with anti-drip edge where baskets can be placed
- 1.2 mm thick pressed top
- Pressed AISI 316L chrome-nickel-molybdenum stainless steel tank (corrosion resistant for use with salt) with rounded corners for ease of cleaning and large starch overflow
- Tank is filled by means of a tap
- Water discharged by means of a ball cock situated in the base
- Electric version with high performance heating elements placed outside the tank

General technical data

Dimensions: (mm) **400x700x900**

Volume: (m³) **0,5**

Weight:: (Kg) **50**

Electrical connection

kW **6**

Power supply voltage **VAC 400/3N 50/60Hz**

Cold water inlet **1/2"**

Outlet **1"**

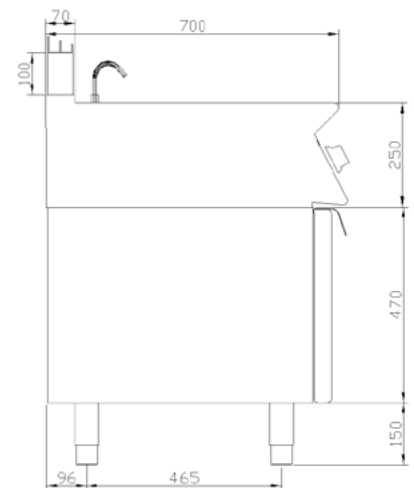
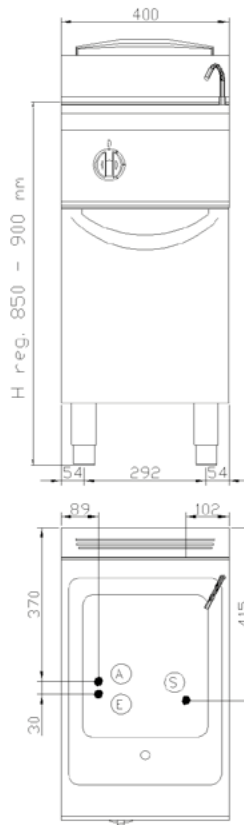

- (G) GAS INLET
- (E) ELECTRICAL PLUG
- (A) WATER INLET
- (C) HOT WATER INLET
- (F) COLD WATER INLET
- (S) WATER DRAIN