

CPG726

26 litre SINGLE TANK GAS PASTA COOKER



- Steel unit with moulded top with anti-drip edge where baskets can be placed
- 1.2mm thick pressed top
- Pressed AISI 316L chrome-nickel-molybdenum stainless steel tank (corrosion resistant for use with salt) with rounded corners for ease of cleaning and large starch overflow
- Tank is filled by means of a tap Water discharged by means of a ball cock situated in the base
- Gas versions with high thermally efficient burners placed under the tank
- Piezo ignition
- Steel cabinet base unit
- Height-adjustable stainless steel feet

General technical data

Dimensions: (mm) **400x700x900**

Volume: (m³) **0,5**

Weight:: (Kg) **52**

Gas connection

kW **10**

UNI ISO 7\1 R 1/2"

Cold water inlet **1/2"**

Outlet **1"**

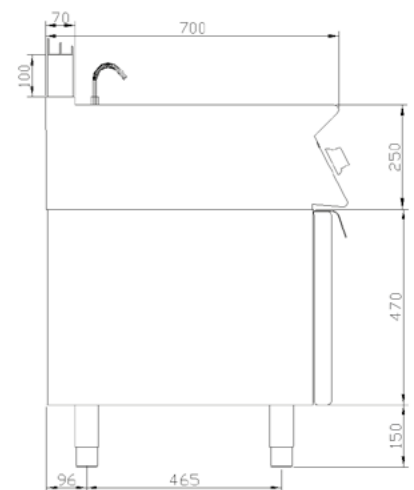
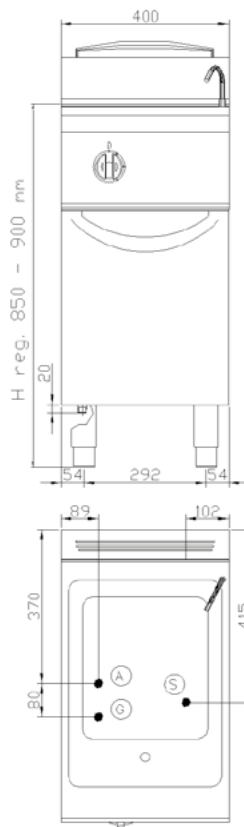

- (G) GAS INLET
- (E) ELECTRICAL PLUG
- (A) WATER INLET
- (C) HOT WATER INLET
- (F) COLD WATER INLET
- (S) WATER DRAIN