

FLE941GX

ELECTRIC FRY TOP WITH OPEN UNIT, SMOOTH DUPLEX 2304 SINGLE PLATE



- Steel unit
- 2 mm thick pressed top lowered by 3 cm compared to the work surface
- Work surface adjustable from 850 to 900 mm
- Built-in plate for even cooking and ease of cleaning.
- Smooth Duplex 2304.
- Top with drain hole and pressed fat collector GN 1/2
- Shaped instrument panel with controls tilted toward the operator
- Heated by plated elements in incoloy
- Warning light on the control panel to indicate heating
- Cooking temperature controlled thermostatically from 50 to 330 °C
- Cooking surface 330x645mm

General technical data

Dimensions: (mm) **800x900x900**

Volume: (m³) **0,9**

Weight: (Kg) **175**

Electrical connection

kW **16**

Power supply voltage **VAC 400/3N
50/60Hz**

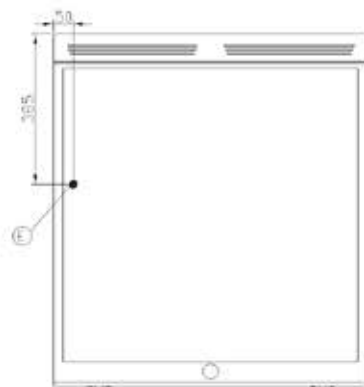
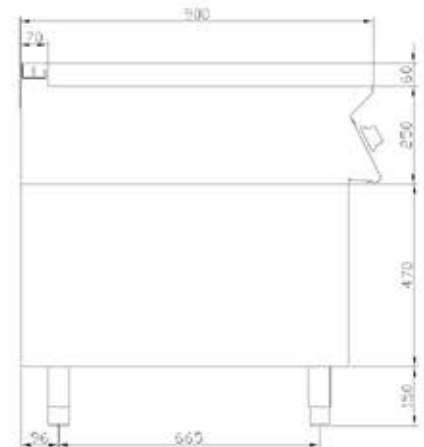

- (G) GAS INLET
- (E) ELECTRICAL PLUG
- (A) WATER INLET
- (C) HOT WATER INLET
- (F) COLD WATER INLET
- (S) WATER DRAIN