

FME941GX
ELECTRIC FRY TOP WITH OPEN UNIT, SMOOTH/RIBBED DUPLEX 2304 PLATE

- Steel unit
- 2 mm thick pressed top lowered by 3cm compared to the work surface
- Height-adjustable cooktop (850-900 mm)
- Built-in plate for even cooking and ease of cleaning.
- Smooth/ribbed Duplex 2304 plate. Cooking surface clad in hard chrome with a mirrored finished
- Top with drain hole and pressed fat collector GN1/2
- Shaped instrument panel with controls tilted toward the operator
- Heated by plated elements in incoloy Warning light on the control panel to indicate heating
- Cooking temperature controlled thermostatically from 110 to 280 °C
- Cooking surface 330x645mm

General technical data

Dimensions: (mm) **800x900x900**

Volume: (m³) **0,9**

Weight:: (Kg) **175**

Electrical connection

kW **16**

Power supply voltage **VAC 400/3N
50/60Hz**

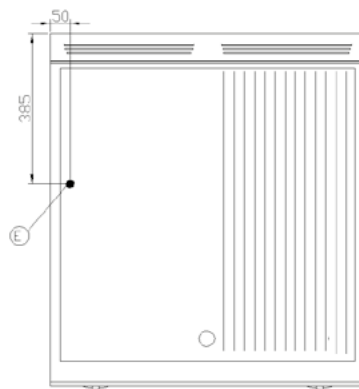
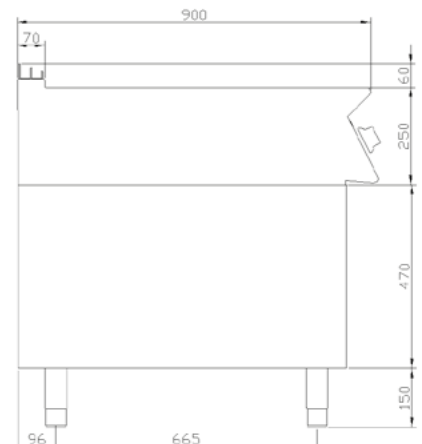
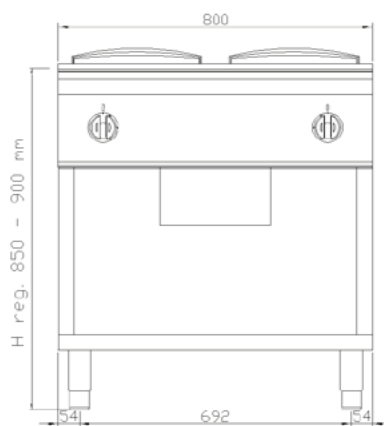

- (G) GAS INLET
- (E) ELECTRICAL PLUG
- (A) WATER INLET
- (C) HOT WATER INLET
- (F) COLD WATER INLET
- (S) WATER DRAIN